

Sequatchie County - Parcel: 024 007.38

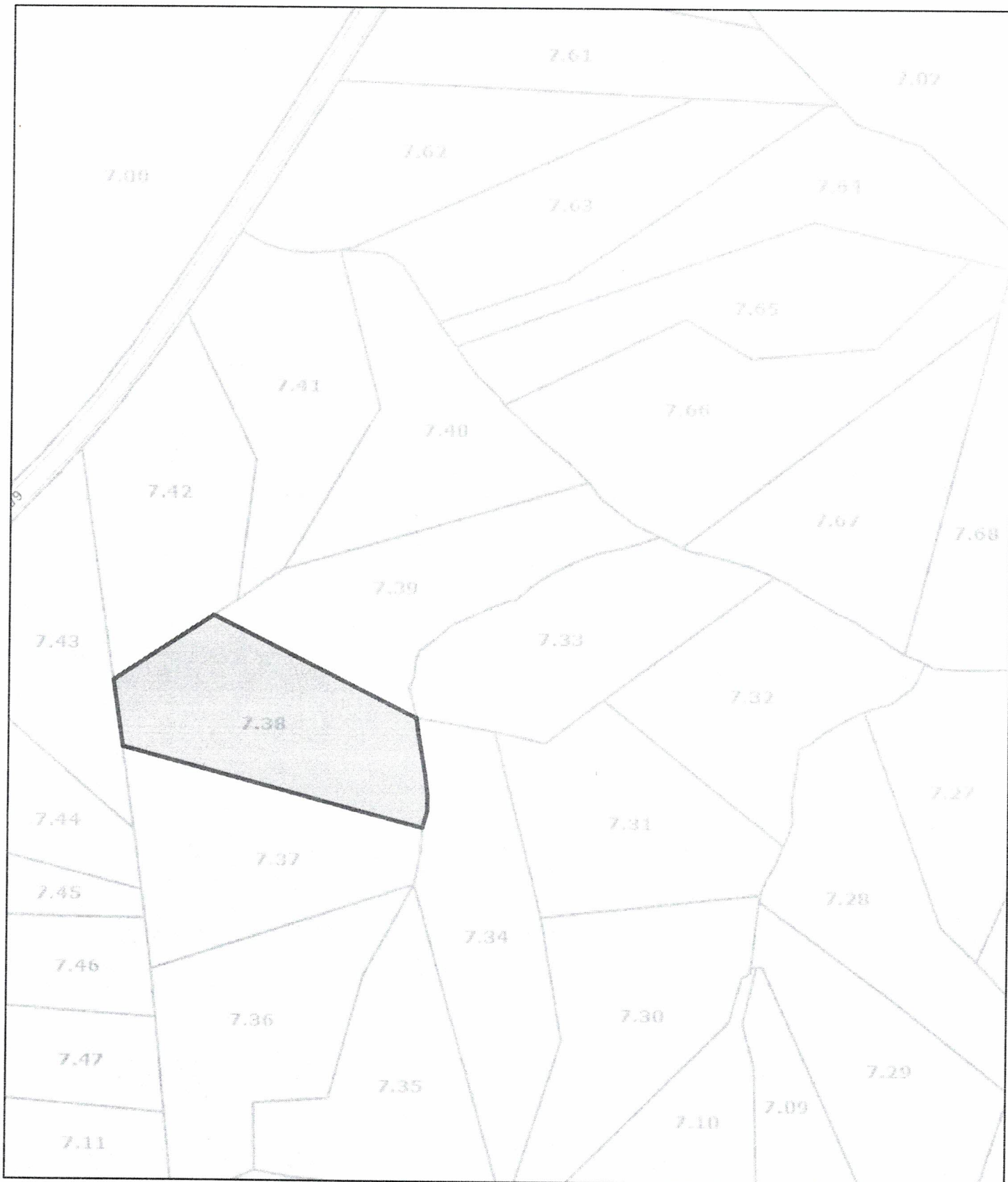

Date: May 9, 2026

County: SEQUATCHIE
Owner: DASH JAMES A. DASH PATRICIA L.
Address: SR 399
Parcel ID: 024 007.38
Deeded Acreage: 5
Calculated Acreage: 5

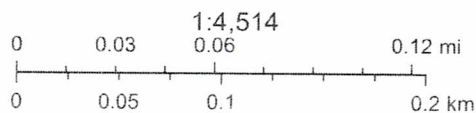

State of Tennessee, Comptroller of the Treasury, Division of Property Assessments (DPA), Esri Community Maps Contributors, © OpenStreetMap, Microsoft, Esri, TomTom, Garmin, SafeGraph, GeoTechnologies, Inc. METI/ NASA, USGS, EPA, NPS, US Census Bureau, USDA, USFWS

The property lines are compiled from information maintained by your local