

Soils Map

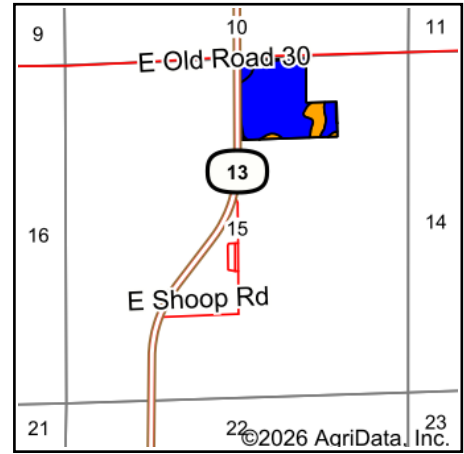

State: **Indiana**
 County: **Kosciusko**
 Location: **15-32N-7E**
 Township: **Washington**
 Acres: **34.73**
 Date: **3/19/2026**

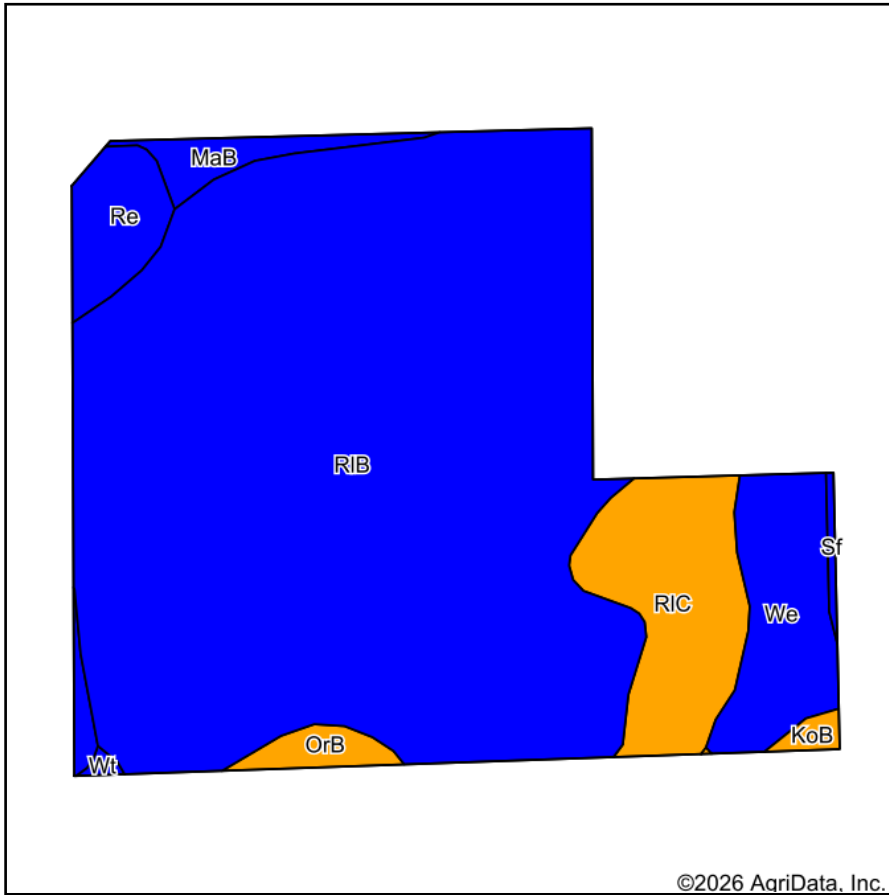

Soils data provided by USDA and NRCS.

©2026 AgriData, Inc.

© AgriData, Inc. 2025

www.AgriDataInc.com

Area Symbol: IN085, Soil Area Version: 28

Code	Soil Description	Acres	Percent of field	Non-Irr Class Legend	Non-Irr Class	Corn Bu	Corn silage Tons	Grass legume hay Tons	Grass legume pasture AUM	Grass legume pasture Tons	Oats Bu	Pasture AUM	Soybeans Bu	Winter wheat Bu
RIB	Riddles fine sandy loam, 2 to 6 percent slopes	26.90	77.3%		Ile	141	1	5	8	8		1	49	58
RIC	Riddles fine sandy loam, 6 to 12 percent slopes	2.97	8.6%		IIle	130	18	4				9	46	65
We	Washtenaw loam, gravelly substratum	2.19	6.3%		IIw	155	21	5				10	46	62
Re	Rensselaer loam, 0 to 1 percent slopes	1.28	3.7%		IIw	167			6			11	49	68
MaB	Martinsville sandy loam, 2 to 6 percent slopes	0.62	1.8%		Ile	135	21	5				9	47	68
OrB	Ormas loamy sand, 2 to 6 percent slopes	0.44	1.3%		IIle	100	16	3				7	35	50
KoB	Kosciusko sandy loam, 2 to 6 percent slopes	0.17	0.5%		IIle	95	17	3				6	33	48
Sf	Sebewa mucky loam	0.10	0.3%		IIw	131					1	9	33	52

Soils data provided by USDA and NRCS.



Code	Soil Description	Acres	Percent of field	Non-Irr Class Legend	Non-Irr Class	Corn Bu	Corn silage Tons	Grass legume hay Tons	Grass legume pasture AUM	Grass legume pasture Tons	Oats Bu	Pasture AUM	Soybeans Bu	Winter wheat Bu
Wt	Whitaker loam	0.06	0.2%		llw	154		5				10	50	69
Weighted Average					2.10	141	4.3	4.9	6.2	6.2	*-	2.9	48.2	59.2