

# Soils Map

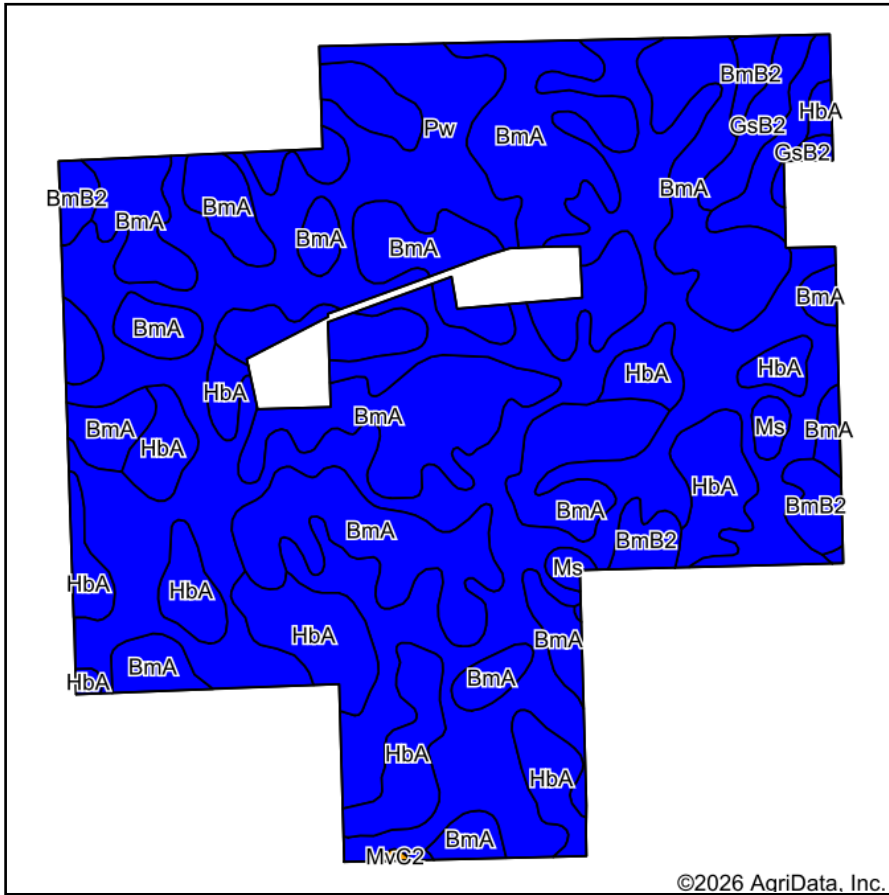

©2026 AgriData, Inc.

Soils data provided by USDA and NRCS.

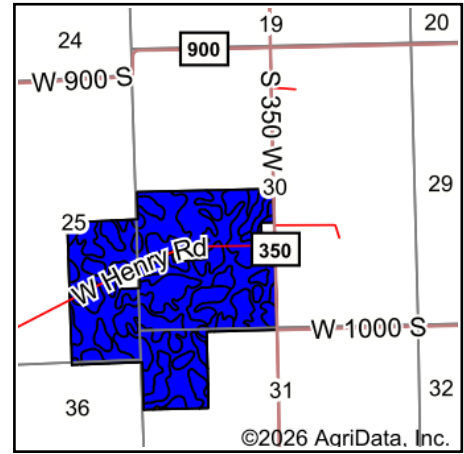

©2026 AgriData, Inc.

State: **Indiana**  
 County: **Whitley**  
 Location: **30-30N-9E**  
 Township: **Washington**  
 Acres: **269.19**  
 Date: **2/18/2026**



Maps Provided By:



© AgriData, Inc. 2025

www.AgriDataInc.com



Area Symbol: IN183, Soil Area Version: 28

Code	Soil Description	Acres	Percent of field	Non-Irr Class Legend	Non-Irr Class	Alfalfa hay Tons	Corn Bu	Corn silage Tons	Grass legume hay Tons	Grass legume pasture AUM	Oats Bu	Pasture AUM	Soybeans Bu	Winter wheat Bu
Pw	Pewamo silty clay loam, 0 to 1 percent slopes	117.70	43.8%		Ilw		157		5	11			47	64
BmA	Blount loam, interlobate moraines, 0 to 2 percent slopes	102.52	38.1%		Ilw		142	17	5			9	52	56
HbA	Haskins loam, 0 to 3 percent slopes	34.95	13.0%		Ilw		158		5	11			59	62
BmB2	Blount loam, interlobate moraines, 1 to 4 percent slopes, eroded	7.61	2.8%		Ile		137	17	5			9	50	54
GsB2	Glywood loam, 2 to 6 percent slopes, eroded	4.42	1.6%		Ile	5	128	18	4	8	78		41	56
Ms	Milford silty clay loam, 0 to 2 percent slopes	1.87	0.7%		Ilw		154		5			11	43	62
MvC2	Morley loam, 6 to 12 percent slopes, eroded	0.12	0.0%		Ille		115	18	4			8	40	52
<b>Weighted Average</b>					<b>2.00</b>	<b>0.1</b>	<b>150.3</b>	<b>7.3</b>	<b>5</b>	<b>6.4</b>	<b>1.3</b>	<b>3.8</b>	<b>50.4</b>	<b>60.3</b>

Soils data provided by USDA and NRCS.